



Minutes

of the

Thames-Coromandel District Council

Ordinary Meeting

Date 18 September 2018
Venue Council Chambers
515 Mackay Street
Thames

Present

SA Goudie (Mayor)	HD Bartley	PA Brijevich
	SL Christie	S Peters
	GR Simpson	TM Walker

In attendance

Name

Community Board Chairs

Dianne Connors, Ken Coulam, Peter Pritchard and Bob Renton.

Staff

Rob Williams, Ariana Wickliffe, Lisa Madgwick, Karl Dudley, Bruce Hinson, Brian Taylor, Ken Ward, Donna Holland

Meeting commenced 9:00am

Table of contents

Item Business	Page No.
1 Meeting conduct	3
1.1 Apologies	3
1.2 Public forum	3
1.3 Items not on the agenda	3
1.4 Conflict of interest	3
2 Governance, Planning and Strategy	12
2.1 Meeting schedule for 2019	12
2.2 Waikato East Life Education Trust funding request	12
2.3 Dog Control report 2017/18	12
2.4 Whangamata Community Marae Trust request to lease 101 Lindsay Road, Whangamata	13
3 Finance	14
3.1 Request to Council to carry forward unspent capital expenditure budgets from 2017-18 into 2018-19	14
3.2 Chief Executive Out-of-cycle budget	14
3.3 Infrastructure out of cycle budget requests	14
3.4 Roading storm damage report	15
3.5 Hauraki Rail Trail - Totara to Kopu Chip Seal and cattlegrid Removal Project	15
4 Property Matter	15
4.1 Proposed Easement for Right to Convey Water - Rangitui Street, Whangamata	15
5 Governance and Management updates	16
5.1 Chief Executive's Report for June 2018	16
5.2 Members' reports	16
6 Public excluded	17

1 Meeting conduct

1.1 Apologies

It was noted that Rekha Giri-Percival attended on behalf of Board Chair Kelly.

Apologies were received from Board Chair Connors.

213/18 **Resolved**
CL That the Thames-Coromandel District Council receives the apologies from Board Chair Kelly and Board Chair Connors.

Moved/seconded by: McLean/Christie

1.2 Public forum

Denis Tegg spoke to item 6.4 Land Acquisition for the Thames Aquatic & Sport Facility. Mr Tegg tabled his notes and acknowledged his concerns to the use of the airfield site for the new swimming pool in Thames. Mr Tegg advised that a comprehensive legal opinion in coastal hazard law was required before the council commits any more funds to this site.

Mr Tegg also noted that there were other significant issues which were not covered in the Tonkin and Taylor report. Mr Tegg noted that this included land subsidence, relative sea level rise, groundwater intrusion, and the river flooding models were outdated.

214/18 **Resolved**
CL That Thames-Coromandel District Council receives Denis Tegg as a speaker in the public forum.

Moved/seconded by: Fox/Christie

1.3 Items not on the agenda

There were no items added to the agenda.

1.4 Conflict of interest

Deputy Mayor Brljevich declared a conflict of interest to item 1.5 Minutes for confirmation – Mercury Bay Community Board minute in relation to the naming of Huarere Rise.

Councillor Peters declared a conflict to item 3.5 Hauraki Rail Trail – Totara to Kopu Chip seal and Cattle grid removal project advising that he was a representative on the Trust.

1.5 Minutes for receiving and confirmation

215/18 **Resolved**
CL That the Thames-Coromandel District Council

1. Receives the Coromandel-Colville Community Board minutes for the meeting held on the 14 August 2018.
2. Approves the road name Cherry Lane for the Greenhills Subdivision, for Access Lot 79 as shown below

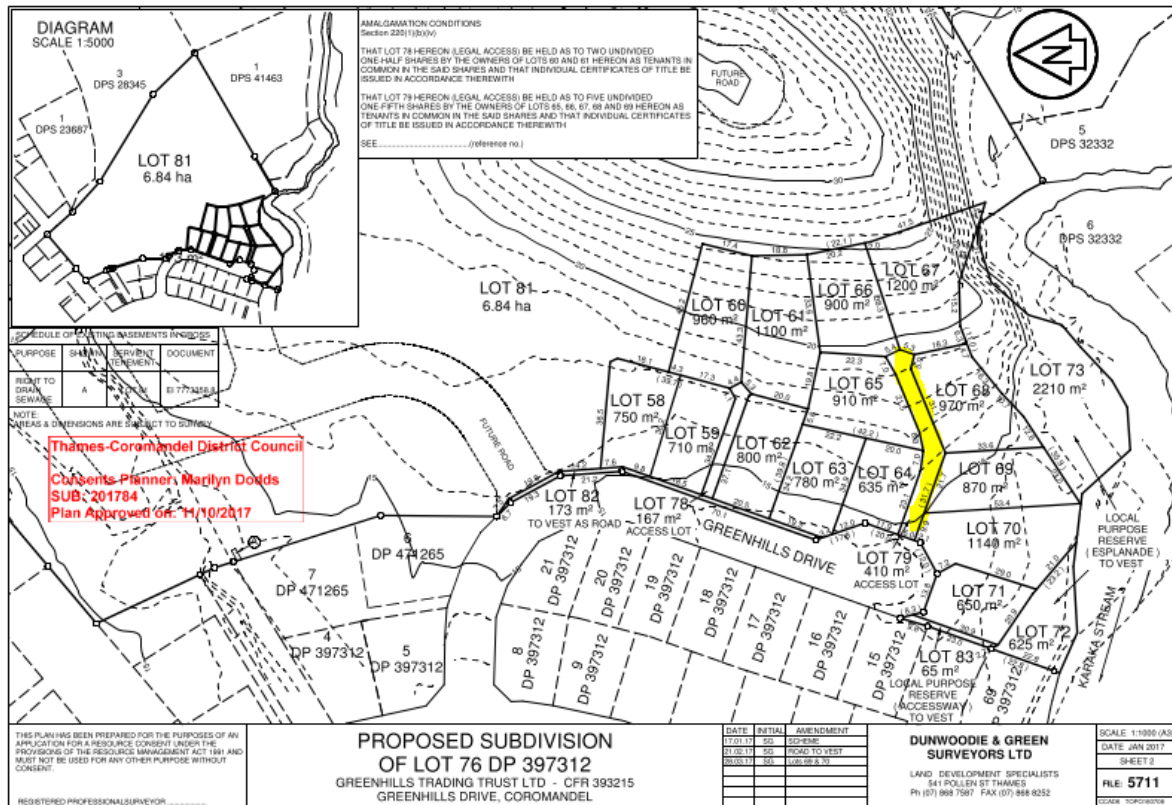

3. Approves the following land vested in Council be classified in accordance with the Reserves Act 1977, s16 (2) (a)
4. Approves the following land parcels be classified as "Recreation reserves" in accordance with the Reserves Act 1977, s17.

Name	Address	Parcel ID	Legal Description	
Hauraki House	230 Kapanga Road, Coromandel	4453964	Sec 24 Block VI Coromandel SD SO 457682,	GN H481638 (NZ Gazette 1983 p 2499) Vested in TCDC in trust for recreation purposes
Long Bay Reserve	2500 Long Bay Rd, Coromandel	4326895	Lot 11 DPS 48837	Vested on deposit of DPS 48837 in TCDC pursuant to s306(4) Local Government Act 1974.
Long Bay Reserve	3500 Long Bay Rd, Coromandel	4300427	Lot 1 DP 29120	GN S107076 (NZ Gazette 1956 p 661) Vested in Coromandel County Council in trust for recreation purposes
Puriri Reserve	10 Puriri Rd, Te Kouma	4311145	Lot 37 DPS 4977	Vested on deposit of DPS 4977 in HM the Queen as Recreation Reserve pursuant to s13 Land Subdivision in Counties Act 1946. Vested in the Coromandel County Council as Recreation Reserve pursuant to s44(1) of the Counties Amendment Act 1961
Carey Road Recreation Reserve	82 Carey Rd, Port Charles	4549547	Lot 17 DPS 4648	Vested on deposit of DPS 4648 in HM the Queen as Recreation Reserve pursuant to s13 Land Subdivision in Counties Act 1946. Vested in the Coromandel County Council as Recreation Reserve pursuant to s44(1) of the Counties Amendment Act

				1961
Sandy Bay Recreation Reserve	1655 Port Charles Rd, Port Charles	4392473	Lot 4 DPS 6642	Vested on deposit of DPS 6642 in HM the Queen as Recreation Reserve pursuant to s13 Land Subdivision in Counties Act 1946. Vested in the Coromandel County Council as Recreation Reserve pursuant to s44(1) of the Counties Amendment Act 1961
Whittle Reserve	993 Colville Rd, Colville	6807362	Sec 1 SO 354749	Vested as Recreation Reserve on SO Plan 354749
Woods Road Reserve	11 Woods Road South, Waitete Bay	4533311	Lot 12 DPS 7199	Vested on deposit of DPS 7199 in HM the Queen as Recreation Reserve pursuant to s13 Land Subdivision in Counties Act 1946. Vested in the Coromandel County Council as Recreation Reserve pursuant to s44(1) of the Counties Amendment Act 1961
Driving Creek Reserve	525A Driving Creek Rd, Coromandel	4257305	Lot 3 DPS 25429	Vested on deposit of DPS 25429 in TCDC pursuant to s306(4) Local Government Act 1974.

5. Approves the following land parcels be classified as "Local Purpose Reserve" in accordance with the Reserves Act 1977 s23

Name	Address	Parcel ID	Legal Description	Local Purpose Reserve
				Municipal Purposes
Samuel James Reserve	74 Kapanga Rd, Coromandel	4321747	Sec 1 SO 60831	Vested in TCDC through GN B512272.2 (NZ Gazette 1998 p 4295),
Admiral Arms Reserve	155 Wharf Road, Coromandel	7521050	Part Parangu 3 & 9 Blocks, DP 1786	Transfer 211683 to Coromandel County
				Esplanade
225R Driving Creek	19 Colville Rd, Coromandel	4336528	Lot 4 DPS 51432	Vested on deposit of DPS 51432 in TCDC pursuant to s306(4) Local Government Act 1974.
	19 Colville Rd, Coromandel	4399802	Lot 3 DPS 68323	Vested on deposit of DPS 68323 in TCDC pursuant to s239(1)(a) Resource Management Act 1991.
Long Bay esplanade – north	254 Colville Rd, Kikowhakarere, Coromandel	4455473	Lot 18 DPS 48836	Vested on deposit of DPS 48836 in TCDC pursuant to s306(4) Local Government Act 1974.
Long Bay Esplanade Reserves - southern	3155 Long Bay Rd, Coromandel	4485834	Lot 25 DPS 87060	Vested on deposit of DPS 87060 in TCDC pursuant to s239(1)(a) Resource Management Act 1991.
McGregor Bay Esplanade	1455 Long Bay Rd, Coromandel	4373628	Sec 7 Block V Coromandel SD	GN S260982 (NZ Gazette 1963 p 881) Vested in Coromandel County Council in trust for esplanade purposes
Carey Road Esplanades	1424A Port Charles Rd, Port Charles	4481943	Lot 4 DPS 46619	Vested on deposit of DPS 46619 in TCDC pursuant to s306(4) Local Government Act 1974.
	1424A Port Charles Rd, Port Charles	4548907	Lot 3 DPS 46619	Vested on deposit of DPS 46619 in TCDC pursuant to

				<i>s306(4) Local Government Act 1974.</i>
	<i>82 Carey Rd, Port Charles</i>	<i>4548907</i>	<i>Lot 1 DPS 4648</i>	<i>Vested on deposit of DPS 4648 in HM the Queen as Esplanade Reserve pursuant to s13 Land Subdivision in Counties Act 1946. Vested in the Coromandel County Council as Esplanade Reserve pursuant to s44(1) of the Counties Amendment Act 1961</i>
	<i>147A Carey Rd, Port Charles</i>	<i>4399569</i>	<i>Lot 2 DPS 55176</i>	<i>Vested on deposit of DPS 55176 in TCDC pursuant to s306(4) Local Government Act 1974.</i>
<i>Little Bay Esplanade Reserves</i>	<i>27A Little Bay Dr, Waikawau</i>	<i>4410329</i>	<i>Lot 18 DPS 57753</i>	<i>Vested on deposit of DPS 57753 in TCDC pursuant to s306(4) Local Government Act 1974.</i>
<i>Okahutahi Esplanade</i>	<i>1633 Port Charles Rd, Port Charles</i>	<i>4444023</i>	<i>Lot 16 DPS 6642</i>	<i>Vested on deposit of DPS 6642 in HM the Queen as Esplanade Reserve pursuant to s13 Land Subdivision in Counties Act 1946. Vested in the Coromandel County Council as Esplanade Reserve pursuant to s44(1) of the Counties Amendment Act 1961</i>
<i>Otautu Esplanade Reserves</i>	<i>285 Port Jackson Rd, Colville</i>	<i>4539277</i>	<i>Lot 3 DPS 5572</i>	<i>Vested on deposit of DPS 5572 in HM the Queen as Esplanade Reserve pursuant to s13 Land Subdivision in Counties Act 1946. Vested in the Coromandel County Council as Esplanade Reserve pursuant to s44(1) of the Counties Amendment Act 1961</i>
	<i>285 Port Jackson Rd, Colville</i>	<i>4540330</i>	<i>Lot 6 DPS 5572</i>	<i>Vested on deposit of DPS 5572 in HM the Queen as Esplanade Reserve pursuant to s13 Land Subdivision in Counties Act 1946. Vested in the Coromandel County Council as Esplanade Reserve pursuant to s44(1) of the Counties Amendment Act 1961</i>
<i>Waitete Stream Reserves</i>	<i>17 Waitete Bay Rd, Waitete Bay</i>	<i>4255457</i>	<i>Lot 3 DPS 68469</i>	<i>Vested on deposit of DPS 68469 in TCDC pursuant to s239(1)(a) Resource Management Act 1991.</i>
	<i>17 Waitete Bay Rd, Waitete Bay</i>	<i>4470482</i>	<i>Lot 4 DPS 30346</i>	<i>Vested on deposit of DPS 30346 in TCDC pursuant to s306(4) Local Government Act 1974.</i>
	<i>17 Waitete Bay Rd, Waitete Bay</i>	<i>4469681</i>	<i>Lot 13 DPS 7199</i>	<i>Vested on deposit of DPS 7199 in HM the Queen as Esplanade Reserve pursuant to s13 Land Subdivision in Counties Act 1946. Vested in the Coromandel County Council as Esplanade Reserve pursuant to s44(1) of the Counties Amendment Act 1961</i>

Wyuna Bay Esplanade	1100 Wyuna Bay Rd, Wyuna Bay	6929388	Lot 5 DPS 377706	Vested on deposit of DP 377706 in TCDC pursuant to s239(1)(a) Resource Management Act 1991.
	1255 Wyuna Bay Rd, Wyuna Bay	4552847	Lot 5 DPS 31565	Vested on deposit of DPS 31565 in TCDC pursuant to s306(4) Local Government Act 1974.
	400 Ruffins Rd, Wyuna Bay	4418561	Lot 4 DPS 5728	Vested on deposit of DPS 5728 in HM the Queen as Esplanade Reserve pursuant to s13 Land Subdivision in Counties Act 1946. Vested in the Coromandel County Council as Esplanade Reserve pursuant to s44(1) of the Counties Amendment Act 1961
Pitoti Stream Esplanade	83A Whangapoua Rd, SH25, Coromandel	6604971	Lot 5 DP 316839	Vested on deposit of DP 316839 in TCDC pursuant to s239(1)(a) Resource Management Act 1991.
	129 Whangapoua Rd, SH25 Coromandel	4483710	Lot 1 DPS 83666	Vested in Coromandel County Council by Proclamation 12902.
Karaka Stream Esplanade	2 Victoria St, Coromandel	7061210	Lot 69 DP 397312	Vested on deposit of DP 397312 in TCDC pursuant to s239(1)(a) Resource Management Act 1991.
	73 Whangapoua Rd, SH25 Coromandel	4298093 4457001 4452086	Lots 4-6 DPS 32332	Vested on deposit of DPS 32332 in TCDC pursuant to s306(4) Local Government Act 1974.
		4374918 4300371	Lots 3-4 DPS 41463	Vested on deposit of DPS 41463 in TCDC pursuant to s306(4) Local Government Act 1974.
		4342886 4288348 4264809 4561084 4470727 4264811 4357499 4325584 4371754 4455339	Lots 9-18 DPS 397312	Vested on deposit of DP 397312 in TCDC pursuant to s239(1)(a) Resource Management Act 1991.
Whakanekeneke Stream Reserves	350 Lillis Lane, Coromandel	4276090	Lot 31 DPS 29159	Vested on deposit of DPS 29159 in TCDC pursuant to s306(4) Local Government Act 1974.
	325 Lillis Lane, Coromandel	4511852	Lot 32 DPS 29160	Vested on deposit of DPS 29160 in TCDC pursuant to s306(4) Local Government Act 1974.
	64 Lillis Lane, Coromandel	4291713 4293860	Lots 34 & 35 DPS 29158	Vested on deposit of DPS 29158 in TCDC pursuant to s306(4) Local Government Act 1974.
Whangarahi Stream Esplanade	483 Albert St, Coromandel	4337555	Lot 2 DPS 37044	Vested on deposit of DPS 37044 in TCDC pursuant to s306(4) Local Government Act 1974.
		4416117	Lot 2 DPS 49618	Vested on deposit of DPS 49618 in TCDC pursuant to s306(4) Local Government Act 1974.

	101A Kelso Lane, Coromandel	4426585	Lot 3 DPS 28616	Vested on deposit of DPS 28616 in TCDC as pursuant to s306(4) Local Government Act 1974.
	320 Albert St, Coromandel	6718845	Lot 6 DP 341471	Vested on deposit of DP 341471 in TCDC pursuant to s239(1)(a) Resource Management Act 1991.
	2117 Rings Rd, Coromandel	4377230 4297634	Lots 5 & 6 DPS 52703	Vested on deposit of DPS 52703 in TCDC pursuant to s306(4) Local Government Act 1974.
	145 Te Tiki St, Coromandel	4476822	Lot 3 DPS 28350	Vested on deposit of DPS 28350 in TCDC pursuant to s306(4) Local Government Act 1974.
	520 Hauraki Rd, Coromandel	4317380	Lot 4 DPS 33902	Vested on deposit of DPS 33902 in TCDC pursuant to s306(4) Local Government Act 1974.
		4540546 4370748	Lots 3 & 4 DPS 57992	Vested on deposit of DPS 57992 in TCDC pursuant to s306(4) Local Government Act 1974.
		4369147	Lot 3 DPS 55449	Vested on deposit of DPS 55449 in TCDC pursuant to s306(4) Local Government Act 1974.
		4372565 4290987	Lots 5 & 6 DPS 33901	Vested on deposit of DPS 33901 in TCDC pursuant to s306(4) Local Government Act 1974.
Strongman Rd Esplanade	15 Strongman Rd, Coromandel	6865992	Lot 21 DP 365937	Vested on deposit of DP 365937 in TCDC pursuant to s239(1)(a) Resource Management Act 1991.
Waiau Esplanades	2590A Tiki Quarry Rd, Coromandel	4294237	Lot 3 DPS 63691	Vested on deposit of DPS 63691 in TCDC pursuant to s306(4) Local Government Act 1974.
		4369104 4525834	Lots 4 & 6 DPS 69021	Vested on deposit of DPS 69021 in TCDC pursuant to s239(1)(a) Resource Management Act 1991.
	127D The 309 Rd, Coromandel	7393978 7393976	Lots 3 & 4 DPS 448462	Vested on deposit of DP 448462 in TCDC pursuant to s239(1)(a) Resource Management Act 1991.
	129 The 309 Rd, Coromandel	4442244	Lot 3 DPS 49930	Vested on deposit of DPS 49930 in TCDC pursuant to s306(4) Local Government Act 1974.
Manaia/Te Kouma Esplanades	1643 SH25 - Manaia Kereta/Te Kouma	4554309	Lot 4 DPS 69627	Vested on deposit of DPS 69627 in TCDC pursuant to s239(1)(a) Resource Management Act 1991.
	16 Manaia Harbour, Manaia	4409853	Parts Tikouma 5C Block ML 22176	Vested in TCDC as Esplanade Reserve pursuant to s432(7) Maori Affairs Act 1953 by Court Order B083897.1
Ohoni Stream Esplanades	713 SH25 - Manaia Kereta/Te Kouma	4387574 4300328 4309216	Lots 2 - 4 DPS 36782	Vested on deposit of DPS 36782 in TCDC pursuant to s306(4) Local Government Act 1974.
Awakanae Stream Esplanade	1643 SH25 - Manaia Kereta/Te Kouma	4410098 4331384 4336841	Lots 5, 7, 9, 11 DPS 32817	Vested on deposit of DPS 32817 in TCDC pursuant to s306(4) Local Government

		4567029		Act 1974.
<i>Port Charles Wharf Esplanade</i>	<i>26 Port Charles Wharf Rd, Port Charles</i>	4531209	<i>Lot 1 DPS 6011</i>	<i>Vested on deposit of DPS 6011 in HM the Queen as Esplanade Reserve pursuant to s13 Land Subdivision in Counties Act 1946. Vested in the Coromandel County Council as Esplanade Reserve pursuant to s44(1) of the Counties Amendment Act 1961</i>
<i>Stony Bay Esplanade</i>	<i>660 Stony Bay Rd, Port Charles</i>	4373944	<i>Lot 2 DPS 5796</i>	<i>Vested on deposit of DPS 5796 in HM the Queen as Esplanade Reserve pursuant to s13 Land Subdivision in Counties Act 1946. Vested in the Coromandel County Council as Esplanade Reserve pursuant to s44(1) of the Counties Amendment Act 1961</i>
<i>Umangawha Stream Reserve</i>	<i>2308 Colville Rd, Colville</i>	4532116	<i>Lot 6 DPS 35715</i>	<i>Vested on deposit of DP 35715 in HM the King as Esplanade Reserve pursuant to s13 Land Subdivision in Counties Act 1946. Vested in the Coromandel County Council as Esplanade Reserve pursuant to s44(1) of the Counties Amendment Act 1961</i>
<i>Wharf Road Esplanades</i>	<i>116 Wharf Rd, Colville</i>	4347725 4410179	<i>Lots 2 & 4 DPS 9670</i>	<i>Vested on deposit of DPS 39670 in TCDC pursuant to s306(4) Local Government Act 1974.</i>
		4287190	<i>Lot 4 DPS 57752</i>	<i>Vested on deposit of DPS 57752 in TCDC pursuant to s306(4) Local Government Act 1974.</i>
<i>Otautu Esplanade Reserves</i>	<i>285 Port Jackson Rd, Colville</i>	4539277 4477264	<i>Lots 1 & 2 DPS 5572</i>	<i>Vested on deposit of DPS 5572 in HM the Queen as Esplanade Reserve pursuant to s13 Land Subdivision in Counties Act 1946. Vested in the Coromandel County Council as Esplanade Reserve pursuant to s44(1) of the Counties Amendment Act 1961</i>
<i>Wharetaua Stream Esplanade</i>	<i>1851 Colville Rd, Colville</i>	6539198 6539199 6539200 6539206	<i>Lots 6-9 DPS 91898</i>	<i>Vested on deposit of DPS 91898 in TCDC pursuant to s239(1)(a) Resource Management Act 1991.</i>
<i>Little Bay Esplanades</i>	<i>162 Waikanae Valley Rd, Little Bay</i>	4553795	<i>Lot 2 DPS 30927</i>	<i>Vested on deposit of DPS 30927 in TCDC pursuant to s306(4) Local Government Act 1974.</i>
<i>Waimanu Esplanade</i>	<i>76 Waimanu Rd, Little Bay</i>	4254643	<i>Lot 5 DPS 52537</i>	<i>Vested on deposit of DPS 52537 in TCDC pursuant to s306(4) Local Government Act 1974.</i>
<i>Tuateawa Coastal</i>	<i>30 Rabarts Rd, Tuatēawa</i>	4408019	<i>Lot 19 DPS 57753</i>	<i>Vested on deposit of DPS 57753 in TCDC pursuant to s306(4) Local Government Act 1974.</i>
				ACCESSWAY
<i>Long Bay Esplanade Reserves</i>	<i>254 Colville Rd, Kikowhakarere,</i>	4535920	<i>Lot 20 DPS 48836</i>	<i>Vested on deposit of DPS 48836 in TCDC pursuant to</i>

- northern	Coromandel			s306(3) Local Government Act 1974.
Long Bay Esplanade Reserves - southern	3155 Long Bay Rd, Coromandel	4499542	Lot 25 DPS 87060	Vested on deposit of DPS 87060 in TCDC pursuant to s239(1)(a) Resource Management Act 1991.
Long Bay Esplanade Reserves - southern	3155 Long Bay Rd, Coromandel	4308580	Lot 24 DPS 87061	Vested on deposit of DPS 87061 in TCDC pursuant to s239(1)(a) Resource Management Act 1991.
Driving Creek Esplanade	225R Driving Creek Rd, Coromandel	4469942	Sec 3 SO 49721	Certificate H870239. Declaration as local purposes (accessway) reserve under s14 Reserves Act 1977
Lillis Lane/Buffalo Rd Accessway	245 Lillis Lane, Coromandel	4413924	Lot 33 DPS 29157	Vested on deposit of DPS 29157 in TCDC pursuant to s306(4) Local Government Act 1974.

6. Approves the following land parcels be classified as "Scenic Reserve" in accordance with the Reserves Act 1977 s19.

<i>Name</i>	<i>Address</i>	<i>Parcel ID</i>	<i>Legal Description</i>	
Wyuna Scenic Reserve	1255 Wyuna Bay Rd, Wyuna Bay	4552846	Lot 4 DPS 31565	Vested on deposit of DPS 31565 in TCDC pursuant to s306(4) Local Government Act 1974.
Kauri Scenic Reserve	1655 Colville Rd, Amodeo Bay	4272319	Lot 4 DPS 68469	Vested on deposit of DPS 68469 in TCDC pursuant to s239(1)(a) Resource Management Act 1991.
Kauri Scenic Reserve	1655 Colville Rd, Amodeo Bay	4338664	Part 6 DPS 30348	Vested on deposit of DPS 30348 in TCDC pursuant to s306(4) Local Government Act 1974.
Kauri Scenic Reserve	1611 Colville Rd, Amodeo Bay	4337571	Section 1 SO 58283	Gazette Notice B120583 Declaration as Scenic Reserve under s14 Reserves Act 1977

7. Approves the following reserves be classified as "Historic Reserve" in accordance with the Reserves Act 1977 s18.

<i>Name</i>	<i>Address</i>	<i>Parcel ID</i>	<i>Legal Description</i>	
Otautu Historic Reserve	285 Port Jackson Rd, Colville	4423468	Lot 20 DPS 5572	Vested on deposit of DPS 5572 in HM the Queen as Esplanade Reserve pursuant to s13 Land Subdivision in Counties Act 1946. Vested in the Coromandel County Council as Esplanade Reserve pursuant to s44(1) of the Counties Amendment Act 1961
Memorial Reserve	355 Kapanga Rd, Coromandel	4529447	Lot 3 DPS 45087	Certificate H601226. Declaration as Historic reserve under s14 Reserves Act 1977

8. Approves that in accordance with the Reserves Act 1977 s16 (5) that the Chief Executive be delegated to proceed to Gazettal of the above reserves.

Moved/seconded by: Brljevich/Simpson

216/18 Resolved

CL That the Thames-Coromandel District Council

1. Receives the Mercury Bay Community Board minutes for the meeting held on the 22 August 2018.
2. Rescinds the following resolution made on 2 March 2016: to approve Huarere Heights for the Pacific View Developments Limited subdivision, stage 2 and 3.
3. Approves the road name Huarere Rise for the Pacific View Developments Limited subdivision, stage 2 and 3.
4. Approves the road name Lois Lane for the Eight Acres Subdivision, for Right of Way serving Lots 1-8.
5. Approves that the new Licence fee chargeable to JI & GJ Morgan under their Licence to Occupy be set at \$520.00 (inc GST) per annum for the period 1 July 2018 to 30 June 2023.

Moved/seconded by: Fox/McLean**217/18 Resolved**

CL That the Thames-Coromandel District Council

1. Receives the Tairua-Pauanui Community Board minutes for the meeting held on the 13 August 2018.
2. Supports, in principle the Council becoming the controlling Authority for Stage 2 of the Pauanui to Tairua Trail subject to a Memorandum of Understanding that establishes the Hikuai District Trust will be responsible for the track's maintenance.
3. Directs staff to work with the Hikuai District Trust to establish a Memorandum of Understanding to be presented to the Tairua-Pauanui Community Board's September 2018 meeting.

Moved/seconded by: Bartley/Walker**218/18 Resolved**

CL That the Thames-Coromandel District Council

1. Receives the Thames Community Board minutes for the meeting held on the 20 August 2018.
2. Replaces \$266,216 (the total capital expenditure to modify the Thames Civic Centre less the three years' of commercial lease revenue) of the Thames Local Consolidated Depreciation reserves from district funding (to be loan funded with operational costs from the 2018/19 surplus/deficit) now that the commercial lease revenue was no longer available given the Council Leases and Licences to Occupy Policy had changed.

Moved/seconded by: Christie/Simpson**219/18 Resolved**

CL That the Thames-Coromandel District Council

1. Receives the Whangamata Community Board minutes for the meeting held on the 21 August 2018.
2. Approves the road name Rewarewa Rise for the Kotuku Enterprises Limited subdivision, for Access Lot 100.

Moved/seconded by: Walker/Bartley

220/18 Resolved

CL That the Thames-Coromandel District Council receives the Infrastructure Committee minutes for the meeting held on 28 August 2018.

Moved/seconded by: McLean/Walker

221/18 Resolved

CL That the Thames-Coromandel District Council

1. Confirms the minutes for the Thames-Coromandel District Council meeting held on the 7 August 2018 as a correct record of proceedings.
2. Confirms the minutes for the Thames-Coromandel District Council Proposed Alcohol Control Bylaw Hearing held on 28 August 2018 as a correct record of proceedings.

Moved/seconded by: Christie/Walker

2 Governance, Planning and Strategy

2.1 Meeting schedule for 2019

Council was asked to adopt the meeting schedule for Council, the Standing Committees and Community Boards for the 2019 year.

222/18 Resolved

That the Thames-Coromandel District Council:

1. Receives the 'Meeting schedule for 2019' report, dated 30 August 2018.
2. Adopts the 2019 meeting schedule as included as Attachment A in the agenda report.

Moved/seconded by: Fox/Peters

2.2 Waikato East Life Education Trust funding request

Council was asked to consider a funding request from Waikato East Life Education Trust for \$12,000 annually for the next three years.

223/18 Resolved

CL That the Thames-Coromandel District Council:

1. Receives the 'Waikato East Life Education Trust funding request' report, dated 14 August 2018.
2. Approves an annual grant to Waikato East Life Education Trust of \$12,000 plus GST (with future inflation adjustments) for three years with the 2018/19 funding to be funded from the year end district surplus/deficit.

Moved/seconded by: Brljevich/Simpson

2.3 Dog Control report 2017/18

Council was presented with the Dog Control report for the 2017/2018 year for adoption as required under section 10A of the Dog Control Act 1996.

224/18
CL**Resolved**

That the Thames-Coromandel District Council:

1. Receives the 'Dog Control report 2017/18' report, dated 27 August 2018.
2. Adopts the 'Thames-Coromandel District Council Annual Dog Control Report 2017/18' provided as **Attachment A** in the agenda report.
3. Instructs staff to send a copy of the 'Thames-Coromandel District Council Annual Dog Control Report 2017/18' (Attachment A) to the Secretary of Local Government.

Moved/seconded by: McLean/Simpson

2.4 Whangamata Community Marae Trust request to lease 101 Lindsay Road, Whangamata

Council was asked to provide direction on the next steps in considering the Whangamata Community Marae Trust's request to lease 101 Lindsay Road, Whangamata and to approve the appropriate resourcing and actions.

Deputy Mayor Brijevich queried if there was an option to sell the land and potentially purchase land at a lesser cost. Mayor Goudie supported Deputy Mayor Brijevich comments and requested that this idea be explored.

Councillor Christie noted that challenges that Council faced with making a decision she understood both the financial responsibility and the social benefit to the community.

Councillor Peters commented that the public good aspect and the opportunity to enhance the cultural and social benefits far exceeded the sale of the land.

Councillor Walker spoke to his notes and advised that he was disappointed with the report recommendations, he highlighted that the piece of land had not been effectively used for twenty years and this an opportunity for the land to be utilised.

Councillor McLean noted that the land was district so district principles of sale and purchase should apply.

Councillor Simpson suggested that a partnership approach be considered between the Community Marae Trust and the Community Board to obtain the land.

Council did not support the disposal of land until further investigations took place. Chief Executive Rob Williams noted that other options would be taken into consideration to both the Marae and property.

225/18
CL**Resolved**

That the Thames-Coromandel District Council:

1. Receives the 'Whangamata Community Marae Trust request to lease 101 Lindsay Road, Whangamata report, dated 5 September 2018.
2. Reject the request as presented and resolve to research other options in relation to both the Marae and the property.

Moved/seconded by: Simpson/Peters

3 Finance

3.1 Request to Council to carry forward unspent capital expenditure budgets from 2017-18 into 2018-19

Council was asked to approve a carry forward of 17 unspent project budgets from 2017-18 into the 2018-19 financial year.

226/18 **Resolved**

CL That the Thames-Coromandel District Council:

1. Receives the 'Carry forward budget request' report dated 20 August 2018.
2. Approves the carry forward requests from the 2017-18 financial year to the 2018-19.

Moved/seconded by: McLean/Fox

3.2 Chief Executive Out-of-cycle budget

Council was provided with information relating to the out-of-cycle budget requests where the Chief Executive has exercised his delegated financial authority to approve.

227/18 **Resolved**

CL That the Thames-Coromandel District Council receives the 'Chief Executive out-of-cycle budget approvals' report, dated 28 August 2018.

Moved/seconded by: Christie/Peters

3.3 Infrastructure out of cycle budget requests

Council was asked to approve a budget increase to complete the 2018/19 annual resurfacing programme.

228/18 **Resolved**

CL That the Thames-Coromandel District Council:

1. Receives the 'Infrastructure out of cycle budget requests' report dated 28 August 2018.
2. Approves to fund the additional budget of \$348,554 for the 2018/19 annual resurfacing programme from roading depreciation reserves.
3. Approves the use of loan funding to fund the cost of reinstatement of Coromandel harbours capital works of \$125,000 to be funded from the Coromandel Community Board and coastal and hazard management capital works of \$310,000 to be funded from District general rates.
4. Approves the use of loan funding to fund the cost of reinstatement of community facilities and coastal and hazard management capital works of \$435,000.

Moved/seconded by: Christie/Simpson

3.4 Roothing storm damage report

Council was provided with an update on the recent storm damage incurred on the Council roading network.

- 229/18
CL
- Resolved**
That the Thames-Coromandel District Council:
1. Receives the 'Roothing storm damage report' report, dated 21 August 2018.
 2. Approves an additional budget of \$2,440,495 with \$1,667,718 funded from NZTA subsidy, \$201,000 funded from the Disaster Reserve and \$571,777 funded from district loans.

Moved/seconded by: Fox/Walker

3.5 Hauraki Rail Trail - Totara to Kopu Chip Seal and cattlegrid Removal Project

Council was asked to approve a budget of \$53,165 match funding contribution to the Hauraki Rail Trail – Totara to Kopu Chip Seal and Cattlegrid Removal Project.

- 230/18
CL
- Resolved**
That the Thames-Coromandel District Council:
1. Receives the Hauraki Rail Trail - Totara to Kopu Chip Seal and Cattlegrid Removal Project report dated 17 July 2018.
 2. Approves a budget of \$53,165 to match-fund the predicted MBIE Making Great Rides (MGR9) contribution to the Hauraki Rail Trail - Totara to Kopu Chip Seal and Cattlegrid Removal Project to be funded from the District Roothing activity.

Moved/seconded by: Christie/Simpson

4 Property Matter

4.1 Proposed Easement for Right to Convey Water - Rangitua Street, Whangamata

Council was asked to grant a right to convey water easement over Local Purpose Reserve located at Rangitua Street, Whangamata.

- 231/18
CL
- Resolved**
That the Thames-Coromandel District Council:
1. Receives the 'Proposed Easement for Right to Convey Water - Rangitua Street, Whangamata' report, dated 28 August 2018.
 2. Approves the granting of a right to convey water easement over the easement areas identified as areas AI, AJ, AK and AL on LT Plan 524852, being easements over Local Purpose (Accessway) Reserve, legally described as Lot 203 DP 390650 comprised in computer freehold register 363862 and located at 120A Rangitua Street, Whangamata and proposed Local Purpose (Utility) Reserve, legally described as Lot 201 LT 524852 to be comprised in computer freehold register 838447, and comprising part of land located at 2752 SH 25 Waihi-Whangamata.
 3. Confirms that all costs associated with construction, installation, laying, connection and registration of the right to convey water easement shall be met by the Subdivider

and/or Owners.

4. Delegates to the Chief Executive, authority to complete all necessary steps to complete registration of the easement outlined in this report.

Moved/seconded by: Walker/Brljevich

5 Governance and Management updates

5.1 Chief Executive's Report for June 2018

Council was provided with an overview of the performance of the organisation.

- 232/18
CL
- Resolved**
Receives the 'Chief Executive's Report for month ended 31 July 2018' report, dated 17 August 2018.

Moved/seconded by: Brljevich/Fox

5.2 Members' reports

Deputy Mayor Brljevich noted that ferry service investigations had taken place between Port Charles to the Barrier.

Councillor Christie noted that in early November the Thames Hospital would celebrate 150 years of service. Councillor Christi expressed her concerns to the ongoing shortage within the area and this was her focus for her last year of term.

Councillor McLean attended the Waihou-Piako Catchment Committee on behalf of the Mayor he noted that the Committee's focus was on the eradication of koi carp. Councillor McLean noted the fact the koi carp numbers were becoming more of an issue in the Waterways than cattle stock.

Councillor Fox noted the progress on the Whitianga town centre he explained that he had received nothing but positive feedback.

Councillor Bartley queried the restriction that applied to drones within a town centre.

Councillor Walker noted that the Mangrove Bill had been place on hold.

Councillor Simpson attended the Thame Valley Civil Defence Emergency Management meeting recently. He noted that the Mayor Tony Boone from Whakatane District Council joined them for a discussion on inundation.

Mayor Goudie noted that she and the Chief Executive meet with the owner/manager of Sudima Hotel. Mayor Goudie recently attended the combined service day at the RSA also.

- 233/18
CL
- Resolved**
That the Thames-Coromandel District Council receives the members reports.

Moved/seconded by: Goudie/Simpson

6 Public excluded

234/18 **Resolved**

CL That the public be excluded from the following parts of the proceedings of this meeting namely:

General subject of each matter to be considered	Reason for passing this resolution	Ground(s) under Section 48(1) for the passing of the resolution
<p>6.1 Public Excluded - minutes for receiving and confirmation</p> <ul style="list-style-type: none"> • 22 August 2018 - UNCONFIRMED Mercury Bay Community Board • 20 August 2018 - UNCONFIRMED Thames Community Board • 7 August 2018 - UNCONFIRMED Council meeting <p>6.2 Roding Contract – contract extensions</p> <p>6.3 – Agreement and consent to exchange of land under the Public Works Act 1981 – Waitaia Road, Kuaotunu</p> <p>6.4 – Land acquisition for the Thames Aquatic and Sports Facility</p> <p>6.5 – Proposal – Sheriff Block, Whitianga</p>	<p>(7)(2)(g) – Maintain legal professional privilege.</p> <p>(7)(2)(i) – Enable any local authority holding the information to carry on without prejudice or disadvantage, negotiations (including commercial and industrial negotiations).</p>	<p>(48)(1)(a) – That the public conduct of the whole or the relevant part of the proceedings of the meeting would be likely to result in the disclosure of information for which good reason for withholding would exist.</p>

240/18 **Resolved**

CL That the public be re-admitted to the meeting and resolutions taken with the public excluded be confirmed in the public session except for the following which are to remain in public excluded minute book.

Item	Business
6.1	Public excluded - minutes for receiving and confirmation
6.2	Roding Contract – contract extensions
6.3	Agreement and consent to exchange of land under the Public Works Act 1981 – Waitaia Road, Kuaotunu
6.4	Land acquisition for the Thames Aquatic and Sports Facility
6.5	Proposal – Sheriff Block, Whitianga

Moved/seconded by: Brijevich/McLean

Meeting closed at 11:26am

The foregoing minutes were certified as being a true and correct record of the meeting of the Thames-Coromandel District Council held on 18 September 2018.

Chairperson _____ **Date** _____